

## ENGLISH Manual

### Target audience

From 5 years and older.

### Surface on which you place the play mat

Flat and clean undercarriage (surface)

### Rolling out the play mat

If the play mat is new or has not been used for a longer (long) time, the edges sometimes want to curl. This will automatically level out after fifteen minutes and lie flat. This can be accelerated by placing the play mat over the width direction with the unprinted side on top, and rolling it up briefly. This divides the tension over the mat and it will lie flat faster (see illustration on the right)

### Store the playmat

Standing and rolled up and with a tape or in a tube / original packaging. It is not recommended to put an elastic band around it because after a few days it damages the play mat, you will see after rolling out, a seam where the elastic has been.

### Use

Inside; without shoes and leave flat.

Do not roll in the playmat! For further instructions, see **Safety instructions** in this document.

### Cleaning and drying

Only with water and a cloth is this play mat good to clean; let it dry well before playing with it or storing it.

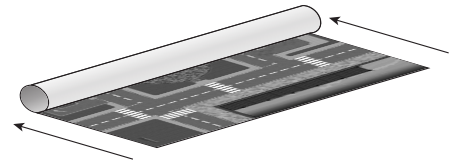

Roll out the play mat

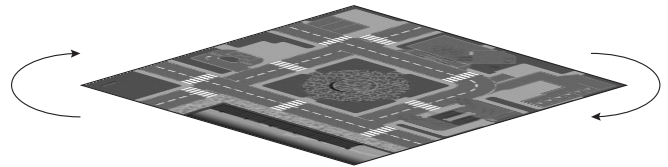

Turn the play mat a quarter turn

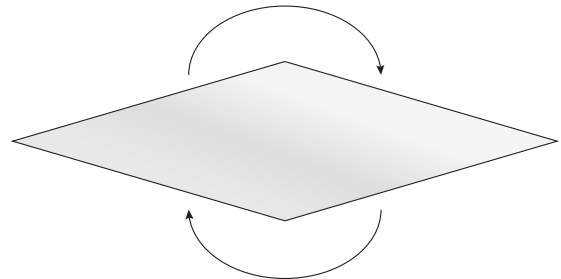

Turn the play mat upside down

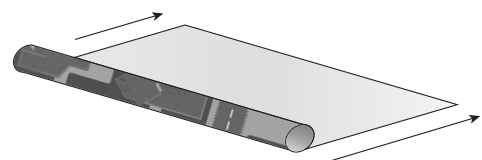

Roll up the play mat

## ENGLISH Safety regulations

For the preservation and the lifespan of this play mat, the advice is to use the play mat indoors and without shoes. Store the play mat rolled up.

The play mat does not have an anti-slip layer, but remains on most surfaces without it shifting; test this where the play mat is used in the environment where it will be located.

Hard or rough play (pressing hard with an object on the play mat) on the play mat is not recommended because then the play mat could be damaged and pieces could come loose from the surface.

**DO NOT LET CHILDREN UNDER 5 YEARS** of age play alone without the supervision of a parent when they play on the play mat, this to prevent suffocation (choking hazard) because the child could roll himself into the play mat.

**DO NOT PUT THE PLAY MAT IN THE MOUTH OR BITE OR CHEW ON IT!**

**DO NOT CUT** into the play mat or **FOLD** the play mat, store rolled up.

**Place the play mat on a clean and flat and dry surface.**

Sand and other imperfections could damage the play mat, causing loose pieces to come off the play mat.

**Remove and dry the play mat.**

If the play mat has become wet or dirty, you can simply clean it with water and a cloth. Let the play mat dry well before using the play mat or rolling it up and storing it again.

**The play mat must NOT come into contact with HOT objects, OPEN FIRE or VOLATILE LIQUIDS** this can permanently damage the play mat and **LEAD TO DANGEROUS SITUATIONS.**

 Do not wash

 Do not bleach

 Should **not** be tumble-dried

 Do not iron

 Do not dry clean



### Discard:

If the play mat is no longer usable or damaged, you must throw it away. You can dispose of the playmat (made of PVC) in coarse household waste or large residual waste that does not fit in the garbage can, you can take to the municipal environmental street.

### Health

The play mats are made of PVC cloth (Known as Frontlit) These contain plasticizer to keep the cloth supple. **THESE PLAY MATS SHOULD UNDER NO CIRCUMSTANCES BE PUT IN THE MOUTH OR CHEWED ON (BITTEN OR CHEWED). THEN PLASTICIZERS COULD BE RELEASED.**

